

Fabric Wrapping Instruction

STEP 1

Attach 12mm width double-sided tape along the full length of the top front edge of the cassette.
Slide fabric with 9mm Strip into the bottom channel.

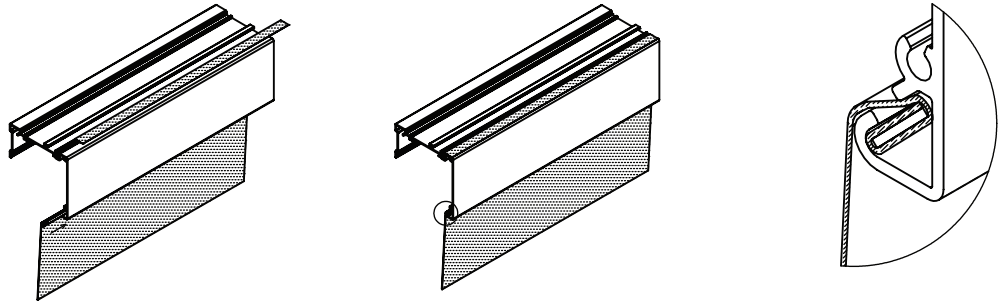

STEP 2

1) Pull fabric over the front of the cassette.
Press fabric firmly onto the adhesive tape to ensure the fabric is taut and flat.
2) Using a flathead screwdriver as a tool, pre-shape the fabric into the groove, and then insert the ribbed spline to secure the fabric.

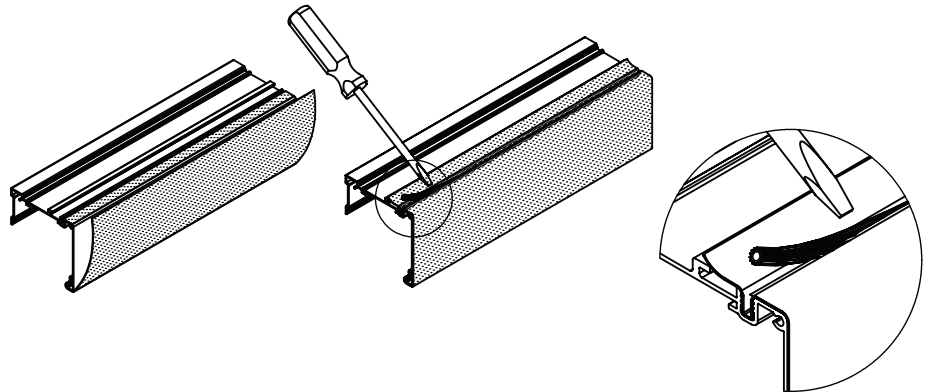

STEP 3

Trim off extra fabric.

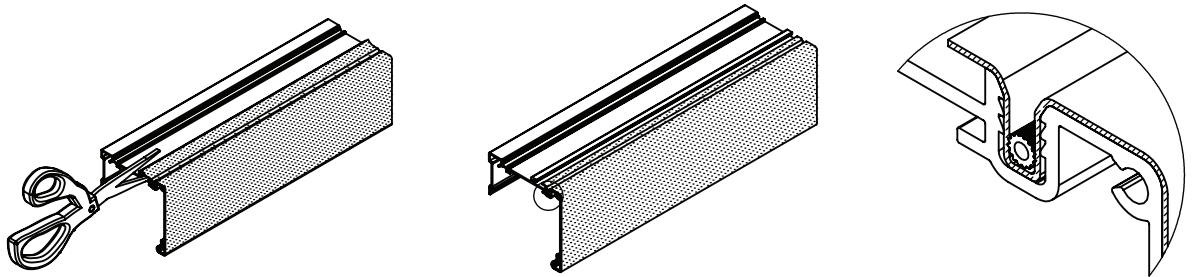

STEP 4

Install a shade with brackets and end caps as usual.
Optional: Slide the wool pile into the top channel.

To prevent product damage during transportation, secure center of roller with suitable packaging materials.

Accessories:

- RS-ECS Adhesive Double Sided Tape 12mm
- ST-030 Ribbed Spline 4.1mm
- ST-032 9mm Strip One Side Tape
- RS-HD3 Wool pile 7mmx10mm

