

Features and Benefits

- Easy Snap on to the Slim Bottom Bar
- Sits in the middle of Slim Bottom Bar so that pulling force is always applied in the middle
- Removable wand
- Wand length: 12" & 24"

New Items Related



Wand

- Assembling of RS-C38 & RS-C39/C40
- Simply insert rod in the hole and press them firmly together

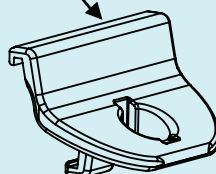

RS-C37

Handle for Slim Bottom Bar
10 pcs/bag

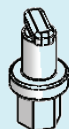

RS-C38

Bottom Bar Hook
10 pcs/bag



RS-C39

Hollow Wand 12" Length
5 pcs/bag

RS-C40

Hollow Wand 24" Length
5 pcs/bag

Slim Bottom Bar

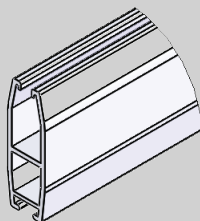

RS-SM1, 2, 3, 4, 5



Website: www.zmc.ca
E-mail: contact@zmc.ca



For more information please contact us at:
Tel: 1.905.856.3838 or 1.800.541.2557

Instructions for Push Up and Pull Down

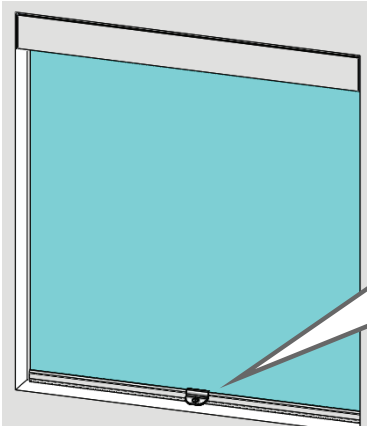

- Snap on Handle to the middle of Slim Bottom Bar

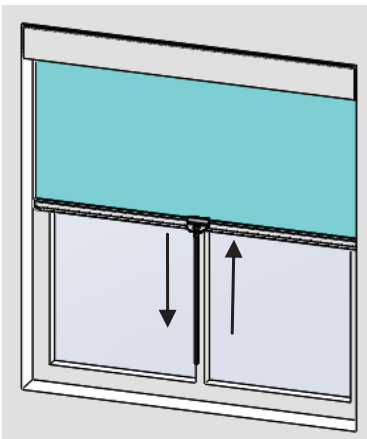
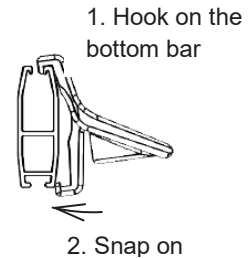

- Let the rectangular end tip of Wand go through the hole of the Handle

- The Wand will push the Handle together with the bottom bar to raise the shade

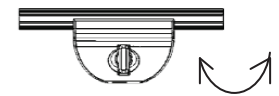
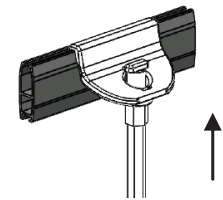
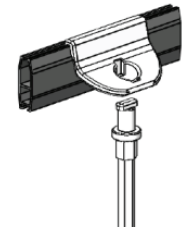

- Turn Wand and let the rectangular end tip sit in the slot of the Handle and pull down the shade

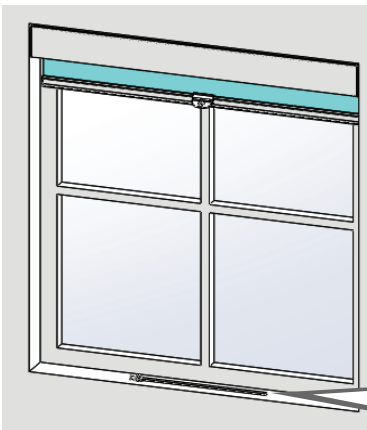
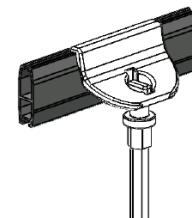

- After shade reaching the desired height, remove Wand from the slot

(Patent Pending)



Website: www.zmc.ca
E-mail: contact@zmc.ca



For more information please contact us at:
Tel: 1.905.856.3838 or 1.800.541.2557